

Quick Guide For 86-Type Smart Switch Panel Touch-Type / Push-Type



1

Specifications

Specifications	Model	Touch:SH-86-1B,SH-86-2B,SH-86-3B Push :SH-P86-1,SH-P86-2,SH-P86-3
Appearance Material	Tempered glass /Plastic	
Button Type	Touch / Push	
Installation	Flush / Surface	
Consumption	Single 10W - 500W	
Standby Power Consumption	≤ 0.5W	
Operating Temperature	-20 °C ~ 60 °C	
Relative Humidity	10% ~ 93% (Non-condensing)	
Dimension	86*86*22 (mm)	

2

Pair With Happy Maria

Pair the panel switch with Happy Maria after the smart switch is installed.
Follow the steps below.

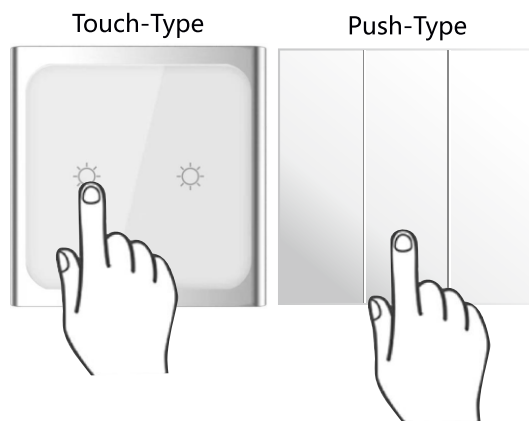

3

Press and hold the switch button for 3 seconds (Hear the buzzer “beep” , which indicates it is in the pairing mode).

User says: Happy Maira.

Happy Maria says : I am here

User says: Turn on the living room light (wall lamp, etc.).

Happy Maria says : The living room light has been turned on.

Hear the buzzer “beep beep ” , which indicates it is successful.

Notice: For more command words, please check user manual for Happy Maria.

Clear the pairing

Press and hold the button for 3 seconds to enter to the pairing mode. Then press and hold the button for 9 seconds. Hear the buzzer “beep beep beep” , which indicates the clearing is successful.

4