

Instruction manual  
**ACCESS CONTROL**

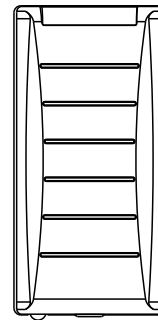

**Mode: DH16A-16DT/CT**  
16 series infrared sensor  
access control

**Mode: DH16A-16DTQ/CTQ**  
16 series infrared sensor  
network access control

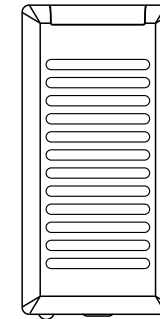

**Mode: DH16A-26DT/CT**  
26 series infrared sensor  
access control

**Mode: DH16A-26DTQ/CTQ**  
26 series infrared sensor  
network access control

CE FC RoHS 





## The pickproof alarm

The built-in buzzer will sent a continuous beeping if the photoresistor sensor is directly exposed into the light. The buzzer will stop automatically in 60s if the light is no longer detected or enter the admin code.

## Detect the door status

When someone opens the door and comes in, the door will be closed, the system will automatically detect the door status and lock the dooreven though it is still in delay period.

### NOTICE

If do operation in a wrong way, it will imply as BI.BI. sounds. The device would turn back without actions in 30s automatically accompany with BI. BI. sounds. It will automatically turn back in 5s with BI.BI. sounds if the code is lost.

The access control will be locked for 60s if swipe the invalid card for 5 times, swiping is not available.

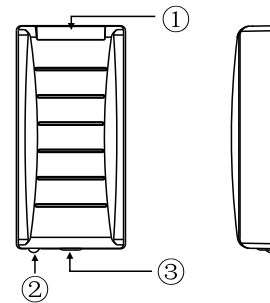

**Mode: DH16A-16DT/CT**  
16 series infrared sensor access control

**Mode: DH16A-16DTQ/CTQ**  
16 series infrared sensor network access control

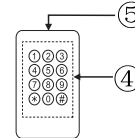

DH12R  
wireless remote control

NO.	Description
①	Mode indicator
②	Infrared area
③	Case screw
④	Keypads
⑤	Antenna

### Working conditions:

temperature: -20°C ~ +50°C  
RH: ≤95%

### Current and voltage requirements:

DC input: ---+12V - +24V  
AC input: ~ 12V - 24V  
standby current: ≤90mA  
working current: ≤120mA

### Applicable card mode:

ID card / IC card

**Cards capacity:** 1000 PCS

**Effective distance:** ≤5cm

NO.	Specifications/Features
1	With internal EM reader / Mifare reader
2	Frequency: 125KHz / 13.56MHz
3	Effective distance: ≤5cm
4	Card access
5	Infrared keypad operation
6	Built-in pickproof function
7	IP rating: 65
8	Dimension: 90x44x20 (mm)

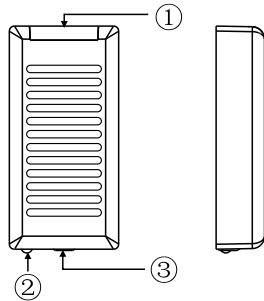

**Mode: DH16A-26DT/CT**  
26 series infrared sensor access control

**Mode: DH16A-26DTQ/CTQ**  
26 series infrared sensor network access control

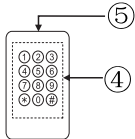

DH12R  
wireless remote control

NO.	Description
①	Mode indicator
②	Infrared area
③	Case screw
④	Keypads
⑤	Antenna

**Working conditions:**

temperature: -20°C ~ +50°C  
RH: ≤ 95%

**Current and voltage requirements:**

DC input: --- +12V - +24V  
AC input: ~ 12V - 24V  
standby current: ≤ 90mA  
working current: ≤ 120mA

**Applicable card mode:**

ID card / IC card

**Cards capacity:** 1000 PCS

**Effective distance:** ≤ 5cm

NO.	Specifications/Features
1	With internal EM reader / Mifare reader
2	Frequency: 125KHz / 13.56MHz
3	Effective distance: ≤ 5cm
4	Card access
5	Infrared keypad operation
6	Built-in pickproof function
7	IP rating: 65
8	Dimension: 90x44x20 (mm)

### Clean all user cards

Enter the setting mode:

Press the button \* and 8 (mode indicator will flash yellow), follow the button 8 twice, a continuous beep will be heard and mode indicator will turn yellow, it indicates all user cards and codes have been cleaned out successfully.

Press the button # to quit the setting mode and standby.

### Restores to factory defaults

Enter the setting mode:

Press the button \* and 8 (mode indicator will flash yellow), follow the button 9 twice, a continuous beep will be heard and mode indicator will turn yellow, it indicates it restores to factory defaults and back to standby mode automatically.

### Turn on/off the pickproof alarm

Enter the setting mode:

Press the button \* and 6 (mode indicator will flash yellow), then following enter the 0 and 1, a long beep will be heard whilst the mode indicator will turn yellow, pickproof alarm is turned off.

Press the button \* and 6 (mode indicator will flash yellow), then following enter the 0 and 2, a long beep will be heard whilst the mode indicator will turn yellow, pickproof alarm is turned on.

Press the button # to quit the setting mode and standby.

### Set access control address

Enter the setting mode:

Press \* 9, indicator light flashes yellow. Enter 03 and Bi sound will be heard. Then enter 6 digits access control address. Bi sound is heard indicates the access control address is set successfully.

Press the button # to quit the setting mode and standby.

### Using the master card to enter the setting mode(For option)

Swipe the master card, a long "BI" will be heard, enter the setting mode. Swipe the master card again, the indicator will turn blue whilst three times rapid beep will be heard, quit the setting mode automatically.

## Add the user card

Enter the setting mode:

Press one number from 000 to 999 data storage units, yellow LED indicator will be flashing:

1. At same time, if red LED indicator lighting, means this number data storage unit existed data, press the button  $\text{⊕}$  twice to clean up;
2. If green LED indicator lighting, means this number data storage unit can be added card in.

Add card steps:

1. Enter in setting mode, and the yellow LED indicator will be flashing.
2. Input three-figure from 000 to 999 data storage units, and the green LED indicator lighting.
3. Swipe card and after a sound "BI", means card added in setting successfully.

Press the button  $\text{⊕}$  to quit setting mode and standby.

## Group cards add in

Enter the setting mode:

Press the button  $\text{⊕}$  and  $\text{Ⓣ}$ , the yellow LED indicator will be flashing, then press the button  $\text{Ⓣ}$  and  $\text{Ⓣ}$ , a sound "BI" as reminder. Then input three-figure 000 to 999 data storage units for start added unit, and input 3 digits number that the whole cards account you want add in. For example:

1. Input 005 060--means the cards added in storage units from 005, and the whole cards added in are 60.
2. Input 060 150--means the cards added in storage units from 060, and the whole cards added in are 150.

## Master Card add in(For option)

Enter the setting mode:

Press the button  $\text{⊕}$  and  $\text{Ⓣ}$ , the mode indicator will flash green, it indicates there is no master card stored, if the indicator turns red, it indicates there is already data existed, press the button  $\text{⊕}$  twice to clean up the data, and then indicator will flash green, swipe the master card, a long beep will be heard, it indicates that adding success.

Press the button  $\text{⊕}$  to quit the setting mode and standby.

-6-

## Wiring Diagram

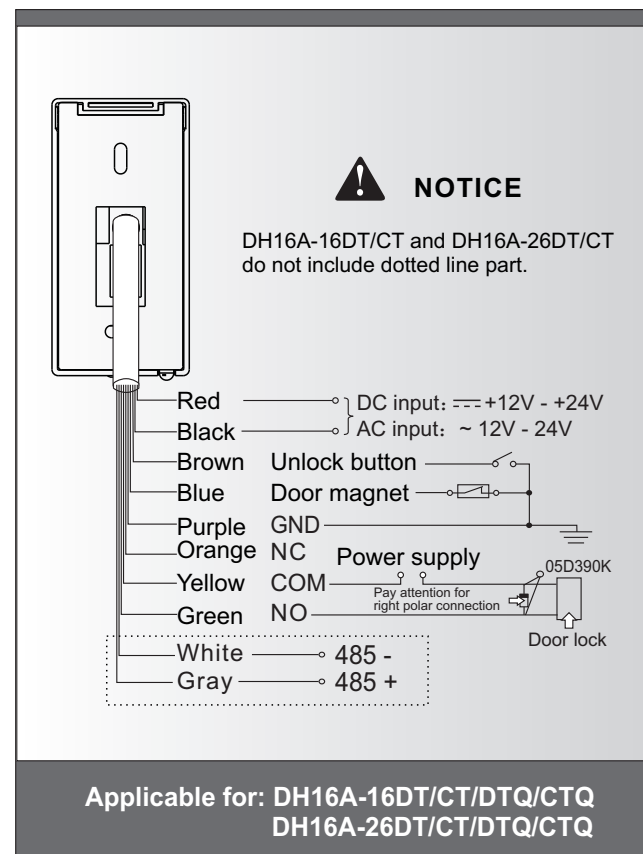

-3-

## Installation

### Applicable mode: DH16A-16DT/CT/DTQ/CTQ DH16A-26DT/CT/DTQ/CTQ

Before installation, position the location where the controller unit is to be mounted, operation according to the following steps:

1. Put the drilling template on the right place, mark the place of the holes, drill the required holes, then have the plastic driven in;
2. Draw the wire through the centre hole of back case, use the screws to mount the back case on the wall, keep it level, then connect the access control according to the wiring diagram;
3. Fix the access control in the back case, then install the front cover. Uplift the bottom of the front cover a little while installing it. At last, screw the unit in the back case and finish the installation.

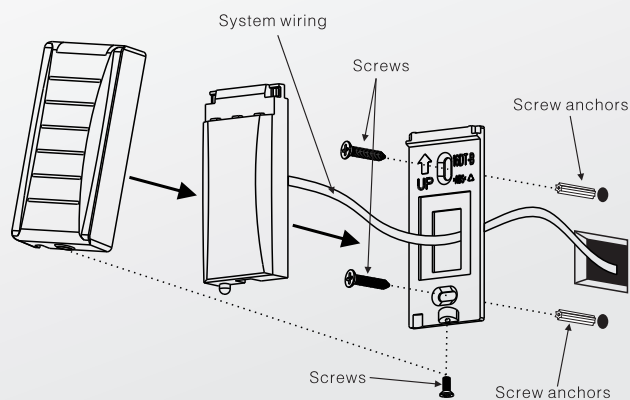

-4-

## Operation (IR control DH12R is necessary)

### Enter the setting mode

Input the administrator code twice (1234+1234), mode indicator will turn yellow.



Default administrator code is 1234

### Modify administrator code

Enter the setting mode:

Press the button  $\odot$  and  $\textcircled{3}$ , the yellow LED indicator will be flashing, then input a new 4-digital administrator code twice, a sounds "BI" means modify succeed.

Press the button  $\#$  to quit the setting mode and standby.



In case forget the administrator code, press the button  $\#$  and hold on, then power on, a sound "BI" as reminder, means administrator code default setting successfully.

### Set the unlocking time

Enter the setting mode:

Press the button  $\odot$  and  $\textcircled{1}$ , the mode indicator will flash yellow, follow the number from 00 to 99, the mode indicator will turn yellow in the mean time a long beep will be heard, it indicates a success of delay time setting. 00-99 means the delay time. I.e. 05 means the unlocking time is 5s delayed. If setting lock-time as 00 means: swipe card once open the door, swipe card again close the door.

Press the button  $\#$  to quit the setting mode and standby.

-5-